

DR-00-4-56

8.025' S 41° 10' 00"
9.100' W 78° 32' 30" (8)

COMMONWEALTH OF PENNSYLVANIA
DEPARTMENT OF MINES

Oil and Gas Division
HARRISBURG

033-20025

QUADRANGLE: Punfield [✓] 7 [1] 15'

PERMIT NO. GLK-23

MAP REFERENCE: 22-24M 2-59 W-108

KIND OF WELL: Gas
(Oil, Gas, Other)

PUNXY-DRIFTWOOD/ROCKTON POOL

WELL RECORD

COMPANY: New York State Natural Gas Corporation

ADDRESS: #2 Gateway Center, Pgh. 22, Pa.

FARMS: Dep. F. & N., Tr. #63 ACRES 1.278

WELL(FARM)NO. 4 CO. SERIAL NO. X-535

ELEVATION: 1798.2 LEASE: 59369

TOWNSHIP: Houston COUNTY: Clearfield

DRILLING DRILLING

COMMENCED: 1-31-57 COMPLETED: 3-28-57

PRODUCTION: 4,115,000 cu. ft.

ROCK PRESSURE: 3340 psig 45 hrs.

WELL TREATMENT: (Shooting, Acidizing, Fracturing
Etc.)

Well was water fraced on 3/26/57 w/12,000 gal.

water & 12,900# of 20/40/sand. Open flow before

frac was 722,000 cu. ft. increased to 4,115,000

cu. ft. after frac.

RESULTS AFTER TREATMENT:

ROCK PRESSURE AFTER TREATMENT: 3340 45 Hrs.

REMARKS:

Size of Casing and Tubing	Used in Drilling	Left in Well	Packers: Type, Size and Depth
13 3/8"	27'	17'	
9 5/8"	812'	808'	815' & 808'
7"	7123'	7112'	815' & 7045'

PERFORATIONS AT:

CEMENTING DATA: (Size Pipe, Depth, No. Bags, Date)

9 5/8" cas. cem. @ 808' w/50 max cem. & 16 max aquagal on 2-16-57

7" cas. cem. @ 7045' w/150 max cem. & 50 max aqu gal on 3-20-57

WELL RECORD

033-20025

4.8 mi E 78° 35' 21

Name Pa. Tract 63, No 4 Co. Clearfield Twp. Huston No. _____
Owner NYS Nat Gas Corp. Contr. _____
Date _____ Elev. 1700 Product * 4 1/2" M. Drill
Obtained by _____ Authority Quadrenfield Sec F

650.0 ft - 100 N.
1900 ft - 100 W.
8050 S 41' 10'
25000 W 70' 30'
Locate by Sketch

2343

Geol. Name	Thick-ness	From	To	Geol. Name	Thick-ness	From	To
DEC 21 1956				JAN 11 1957			
		6388	6500				
		7024					
		7045					
		7074	7102				
			7103				
			Dh				

1-22-57

MAR 29

Tully
Onondaga
Chert
Oriskany
732
778 N of gas B.F.
4115
4500 M.F. R.F.
PP 3340 # 12 hrs
Completed 3-28-57

Loc changed
7024
2045
Jan @ 7:54
1773
5291
1781
1781

sh.

District Sabinsville Map 9S - 16W & 9-59 & W-108
 Loc. Made 1-3-57 Bk. 1767 Pg. 34 El. Bk. 1767 Pg. 38

Latitude 41°10'

Approved _____ Date _____

Longitude 78°30'

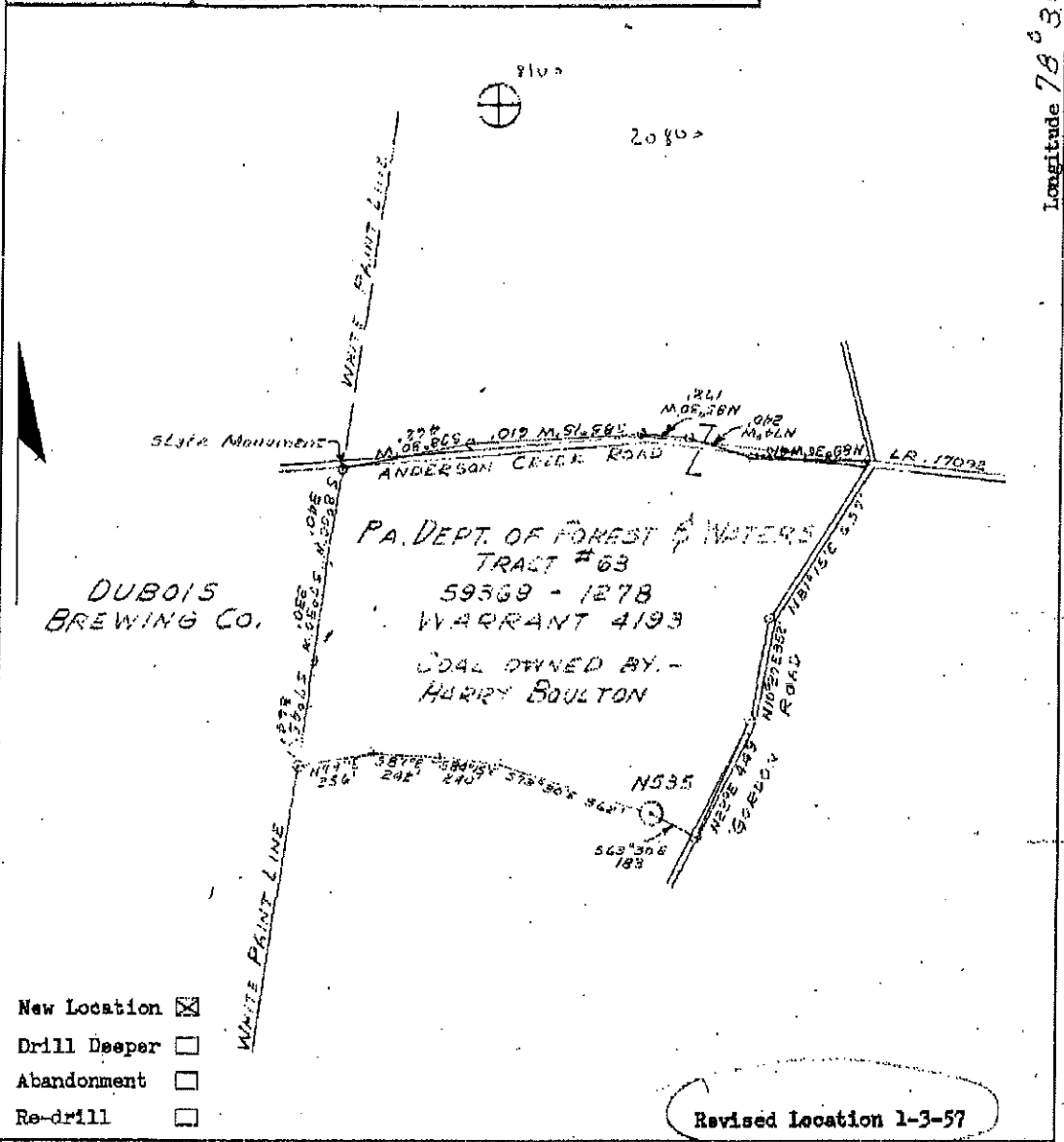

- New Location
- Drill Deeper
- Abandonment
- Re-drill

Revised Location 1-3-57

Company NEW YORK STATE NATURAL GAS CORPORATION
 Address 2 Gateway Center, Pittsburgh 22, Pa.
 Farm Pa. Dept. of Forests & Waters
 Tract 63 Acres 1,278 Lease No. 59369
 Well (Farm) No. 4 Co. Serial No. N-535
 Angle of Deviation, if any _____
 Elevation 1798.2 Quadrangle Penfield
 County Clearfield Township Huston
 Engineer R. A. Doman
 Engineer's Registration No. 14016
 File No. _____ Drawing No. _____
 Date 1-8-57 Scale 1" = 500'

COMMONWEALTH OF PENNSYLVANIA
 DEPARTMENT OF MINES
 Oil and Gas Division
 HARRISBURG
 WELL LOCATION MAP
 Dept. File No. 033-20025
 ⊕ Denotes Values of Well on United States Topographic Maps.
 Scale 15' 7 1/2'
 WORKABLE COAL SEAMS TO BE PENETRATED
 Name of Seam Owner of Seam
Lower Kittanning Harry Boulton

FORMATION	TOP	BOTTOM	GAS AT	OIL AT	WATER AT (Fresh or Salt Water)	REMARKS
Sand	610	780				
Shale	780	1385				
Sandy Shale	1385	2035				
Sand & Shale	2035	2155				
Sandy Shale	2155	2615				
Shale	2615	2955				
Sandy Shale	2955	4040				
Sand & Shale	4040	4130				
Sandy Shale	4130	4780				
Shale & Sandy Shale	4780	4884				
Sandy Shale	4884	4978				
Sand & Shale	4978	5155				
Shale	5155	5370				
Sandy Shale	5370	5740				
Shale	5740	6388				
Lime (Tully)	6388	6500				
Shale	6500	7024				
Lime (Onondaga)	7024	7044				
Chert	7044	7094				
Sand (Oriskany)	7094	7102	7097			
Total Depth		7103				

DM-OG-4-56

3.750' S 41° 10' 00" COMMONWEALTH OF PENNSYLVANIA
4.150' W 78° 32' 30" DEPARTMENT OF MINES
(8)

Oil and Gas Division
HARRISBURG

033-20037

QUADRANGLE: Penfield 7' 15'

PERMIT NO. GLE-37

MAP REFERENCE: 9S 16W 35E W108

KIND OF WELL: Gas
(Oil, Gas, Other)

PUNXY-DRIFTWOOD; ROCKTON POOL.

WELL RECORD

	Size of Casing and Tubing	Used in Drilling	Left in Well	Packers: Type, Size and Depth
COMPANY: <u>New York State Natural Gas Corp.</u>	13 3/8"	17'	9'	
ADDRESS: <u>#2 Gateway Center, Pittsburgh 22, Pa.</u>	9 5/8"	1015'	1007'	BHS @1000'
FARM <u>Helen D. S. Gordon, etal</u> ACRES <u>1050</u>	7"	7372'	7372'	BHS @7312'
WELL(FARM)NO. <u>2</u> CO. SERIAL NO. <u>N-558</u>				
ELEVATION: <u>2040.27</u> LEASE: <u>59665</u>				
TOWNSHIP: <u>Huston</u> COUNTY: <u>Clearfield</u>				
DRILLING COMMENCED: <u>4-1-57</u> DRILLING COMPLETED: <u>5-19-57</u>				
PRODUCTION: <u>3,600,000 cu. ft.</u>				PERFORATIONS AT:
ROCK PRESSURE: <u>2940</u> psig <u>45</u> hrs.				
WELL TREATMENT: (Shooting, Acidizing, Fracturing Etc.) <u>Well hydraulically fractured 5-18-57 w/10,000 gal of water,</u>				
<u>950 lb of gel & 13,500# of 20-40 sand.</u>	CEMENTING DATA: (Size Pipe, Depth, No. Bags, Date			
Volume increased from <u>465,000 cu. ft.</u> to <u>3,600,000 cu. ft.</u>	<u>9 5/8" csg cem. @1000' w/50 sax of cem & 20 sax of aquagel on 4-17-57</u>			
RESULTS AFTER TREATMENT:	<u>7" csg cem. @7312' w/150 sax of cem & 47 sax</u>			
ROCK PRESSURE AFTER TREATMENT:	<u>of aquagel on 5-11-57</u>			

REMARKS:

WELL RECORD 033-20037

Name Helea D.S. Gordon Co. Clearfield Twp. Huston No. 2424

Owner NYS Contr. _____

Date _____ Elev. 2040 Product W Drill _____

Obtained by _____ Authority _____ Quad. 111111 Sec 1

158° 0' W 78' 50"
3700' S 41° 10'

Locate by Sketch

Geol. Name	Thick-ness	From	To	Geol. Name	Thick-ness	From	To
APR 5 1957							
MAY 10 1957							
Tully		7225					
Onondaga		7270					
Clinton		7310					
casing 7312							
MAY 17							
Oriskany		7357	7465				
467 M of B.P.							
FD			7360				
MAY 24 1957							
3000 2500 M of gas A.F.							
RP 2810 psi 24 hrs							
Completed 5-19-57							

District CENTRAL Map 9S-16W * S-58 * W-108
 Loc. Made 3-20-57 Bk. 1782 Pg. 43 Bl. Bk. 1782 Pg. 44
 Approved Thomas D. Kisher Date 3-22-57 ⊕

Latitude 41° 10'

Longitude 78° 30'

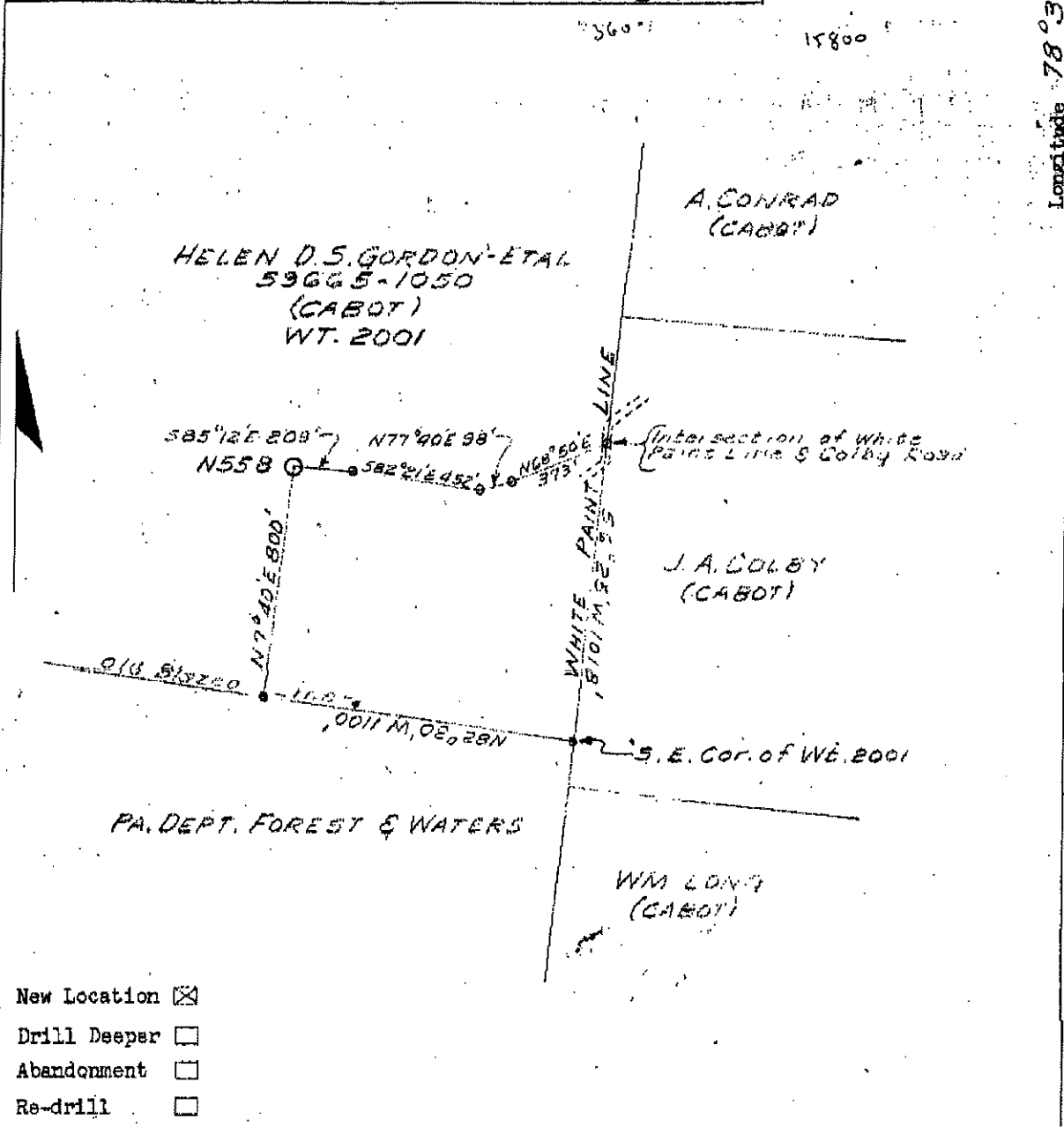

- New Location
- Drill Deeper
- Abandonment
- Re-drill

Company NEW YORK STATE NATURAL GAS CORPORATION
 Address 2 Gateway Center, Pittsburgh 22, Pa.
 Farm Helen D. S. Gordon, et al
 Tract - Acres 1050 Lease No. 59665
 Well (Farm) No. 2 Co. Serial No. N-558
 Angle of Deviation, if any -
 Elevation 2040.27 Quadrangle Penfield
 County Clearfield Township Huston
 Engineer R. A. Doman
 Engineer's Registration No. 14016
 File No. - Drawing No. -
 Date 3-22-57 Scale 1" = 500'

COMMONWEALTH OF PENNSYLVANIA
 DEPARTMENT OF MINES

Oil and Gas Division
 HARRISBURG

WELL LOCATION MAP
 Dept. File No. 033-20037

⊕ Denotes Values of Well on United States Topographic Maps.

Scale 15' 7 1/2'

WORKABLE COAL SEAMS TO BE PENETRATED

Name of Seam Owner of Seam

Lower Kittanning

FORMATION	TOP	BOTTOM	GAS AT	OIL AT	WATER AT (Fresh or Salt Water)	REMARKS
Surface	0	10				
Sand	10	50				
Shale	50	200			137	
Sand	200	245				
Shale	245	370				
Sand	370	425				
Shale & sand	425	480				
Sand	480	515				
Sand & shale	515	535				
Red Rock	535	545				
Sand & shale	545	930				
Sand	930	950				
Red Rock	950	960				
Sand & shells	960	978				
Red Rock	978	990				
Shale & shells	990	1000				

(Over)

FORMATION	TOP	BOTTOM	GAS AT	OIL AT	WATER AT (Fresh or Salt Water)	REMARKS
Lime	1000	1150				
Shale	1150	1385				
Sand	1385	1405				
Sand & shale	1405	1435				
Shale & sand	1435	1585				
Shale	1585	1718				
Sandy shale	1718	3655				
Shale	3655	3795				
Sandy shale	3795	4651				
Shale	4651	5830				
Sandy shale	5830	6015				
Shale	6015	6630				
Lime (Tully)	6630	6750				
Shale	6750	7295				
Lime (Onondaga)	7295	7310				
Chert	7310	7357				
Sand (Oriskany)	7357	7365	Gas			
Lime	7365					
TOTAL DEPTH	7366					

